

Single-phase Transducer

BJ-QPA / QPV

User Manual

Version: 1.2

Features

1. Accurate, reliable, current measurement
2. Measure Single-phase system
3. Input : AC 0~5A (Refer to instrument labels)
4. Output: DC 4 ~ 20 mA , Analog signal (Refer to instrument labels)

Technical parameters

Power Supply	AC 220V(±10%), DC12/24/48V,110V,220V(±20%)
Input	Current : 0~1A/0~5A Voltage: 150V, 300V, 600V
Output	Current : DC 4 ~ 20 mA / DC0~20mA (0~500ohm) Voltage: 0~10V, 0~5V (1K ohm / 500ohm)
Accuracy	≤ ±0.2%RO / ±0.5%RO
Accuracy drift	Annual Variation < 0.2%
Response time	≤ 400 ms
Isolation	Input / output / power supply
Power consumption	DC ≈ 3W, AC ≈ 4VA
Case Material	ABS fireproof materials
Insulation Voltage	AC 2KV RMS / min
Weight	About 350g
Insulation Resistance	Current output: 0<Lr<1K; Voltage output: Lr>5KΩ
Dimension	120 (L) X 55(W) X 75(H) mm
Installation	Fixed in a standard 35mm (1.38 inch) DIN rail or screwed on the cabinet
Working Condition	0 ~ 50 °C/ less than 95% RH (Non-condensing)
Storage Conditions	-20 ~ 70°C/ less than 70% RH (Non-condensing)

Connection drawing

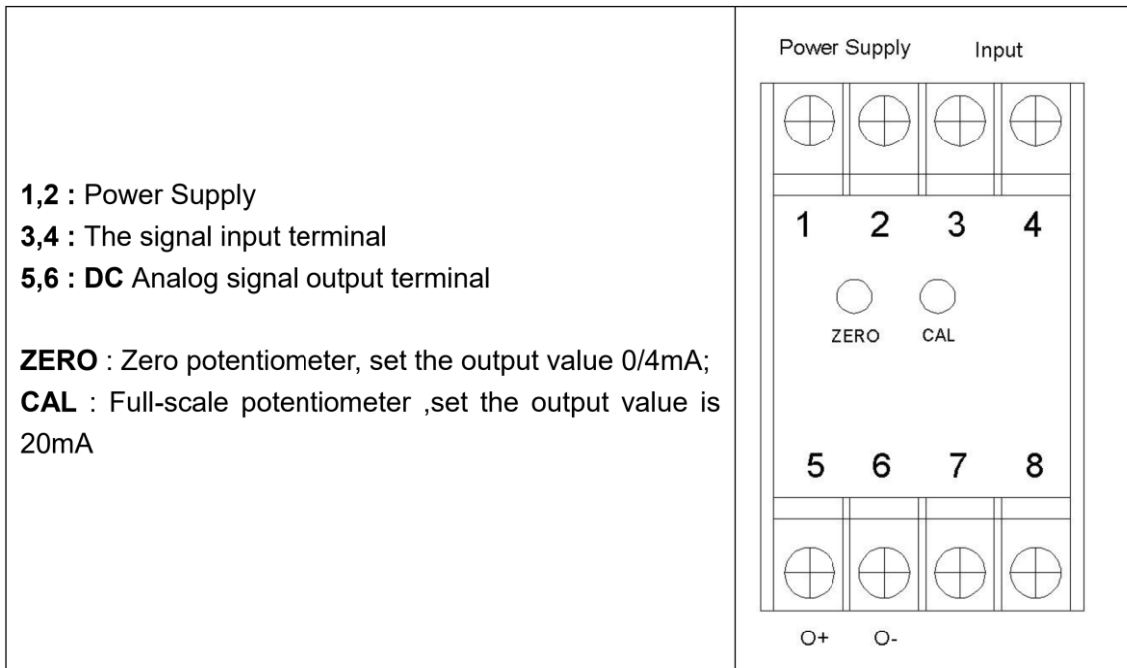

Notes:

1. User need to identify the polarity of output pin,
2. Because different batches of product and customer requirements, please refer to product label

Dimension

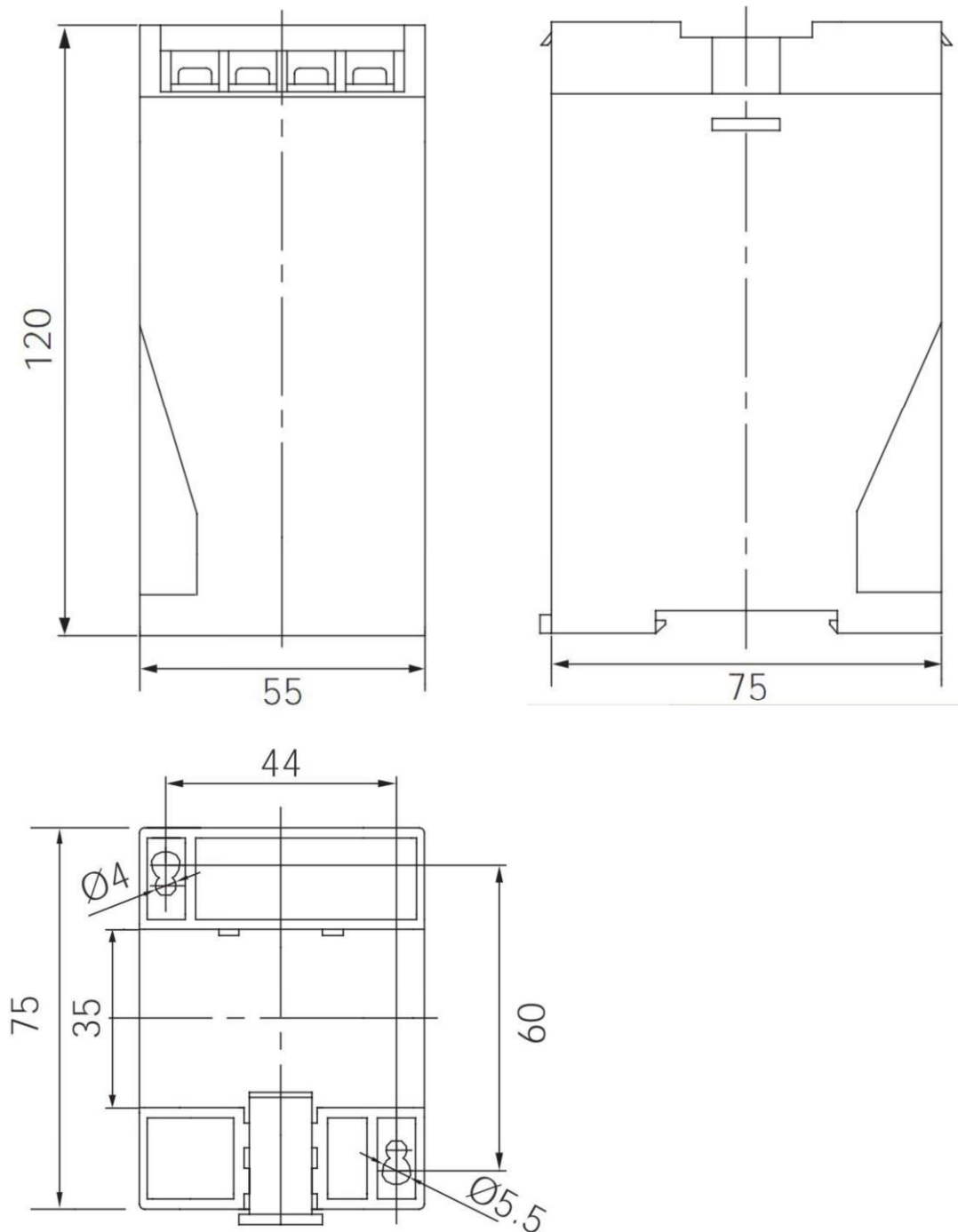

Notes

1. Please confirm the parameter on the label match the order specification
2. Confirm the power supply, input current and voltage
3. Transducer can connect to the CT / PT secondary side

For any inquiry about the instrument performance or whether any failure happens, contact to Blue Jay's technical service.

Blue Jay - After-sales service

*Building 13, 2-8, Jialing third village Pioneer Park,
Jiangbei District , 400020 Chongqing*

Tel - + 0086 023 86850812

Fax - + 0086 023 67636974

E-mail : tech@cqbluejay.com