

Three-Phase Transducer

BJ-QPAX / QPVX

User Manual

Version: 1.3

Features

- AC Voltage Input: 110V,220V,380V optional
- AC Current Input: 0-5A, 5-10A, 0-10A optional
- Output: 0-5V,0-10V,4-20mA, 0-20mA optional
- RMS measurement and output
- 0.2 measurement accuracy
- 200ms response time
- 35mm Din rail mounting
- Support customized parameters

Technical parameters

Power Supply	AC/DC 85~265VAC/DC (..Customer specified)
Signal input	Current(QPAX): 0~1A / 0~5A(..Customer specified) Voltage(QPVX): 0~100V / 0~400V(..Customer specified)
Output	DC 4 ~ 20 mA / 0~20mV / 0-5V / 0-10V
Accuracy	≤ ±0.5%
Accuracy drift	Annual Variation < 0.2%
Response time	≤ 200 ms
Isolation	Input / output / power supply
Power consumption	DC ≈ 3W, AC ≈ 4VA
Case Material	ABS fireproof materials
Insulation Voltage	AC 2KV RMS / min
Weight	About 650g
Insulation Resistance	When DC 500V ,≥100 MΩ
Dimension	120(L) X 110(W) X 75(H) mm
Installation	Fixed in a standard 35mm (1.38 inch) DIN rail or screwed on the cabinet
Working Condition	0 ~ 50C/ less than 95% RH (Non-condensing)
Storage Conditions	-20 ~ 70C/ less than 70% RH (Non-condensing)

Connection drawing

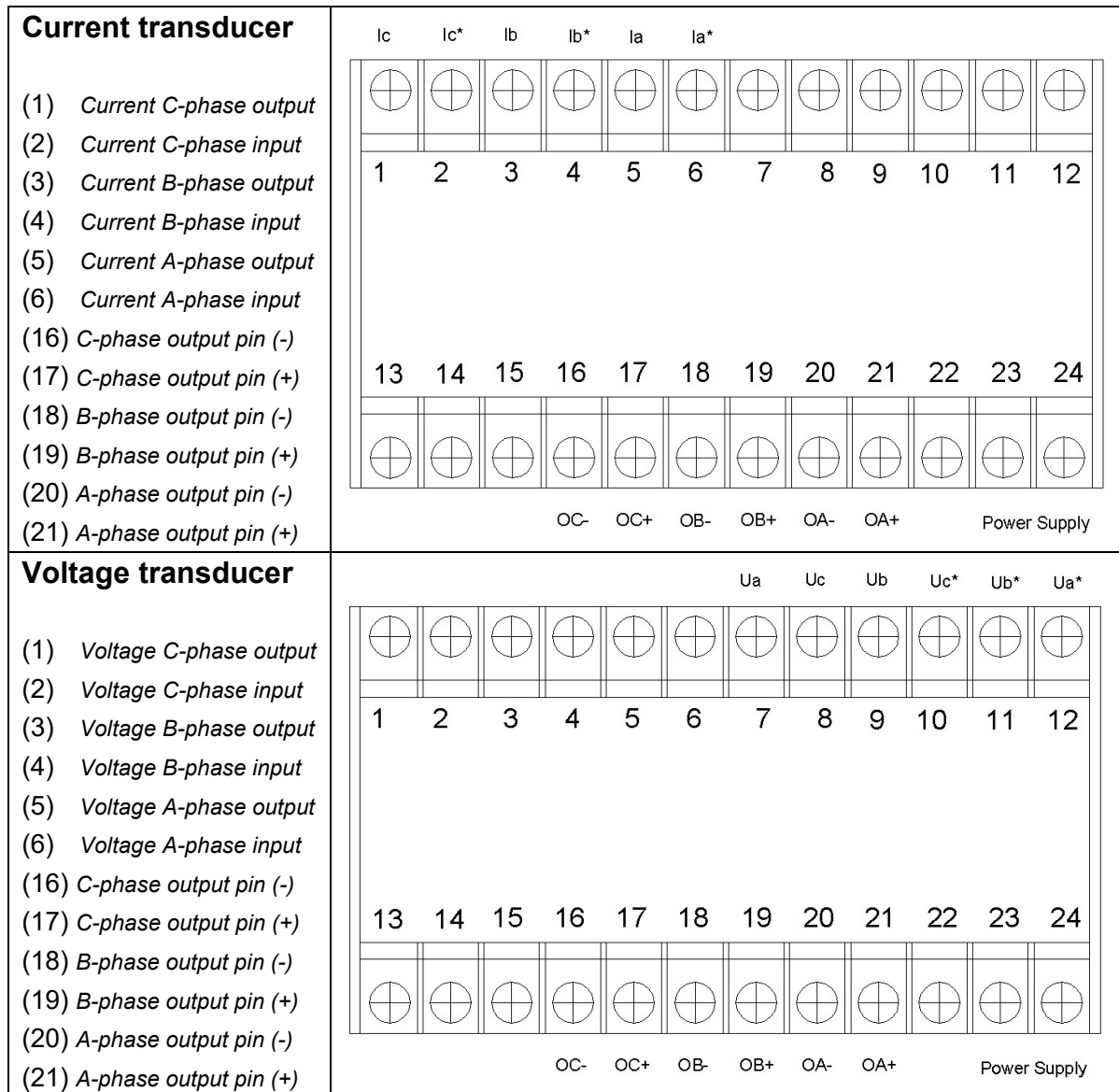

Power Supply : AC/DC 220V

Notes: Listed above picture is for reference!

Detail wiring instructions please refer to product label

Dimension

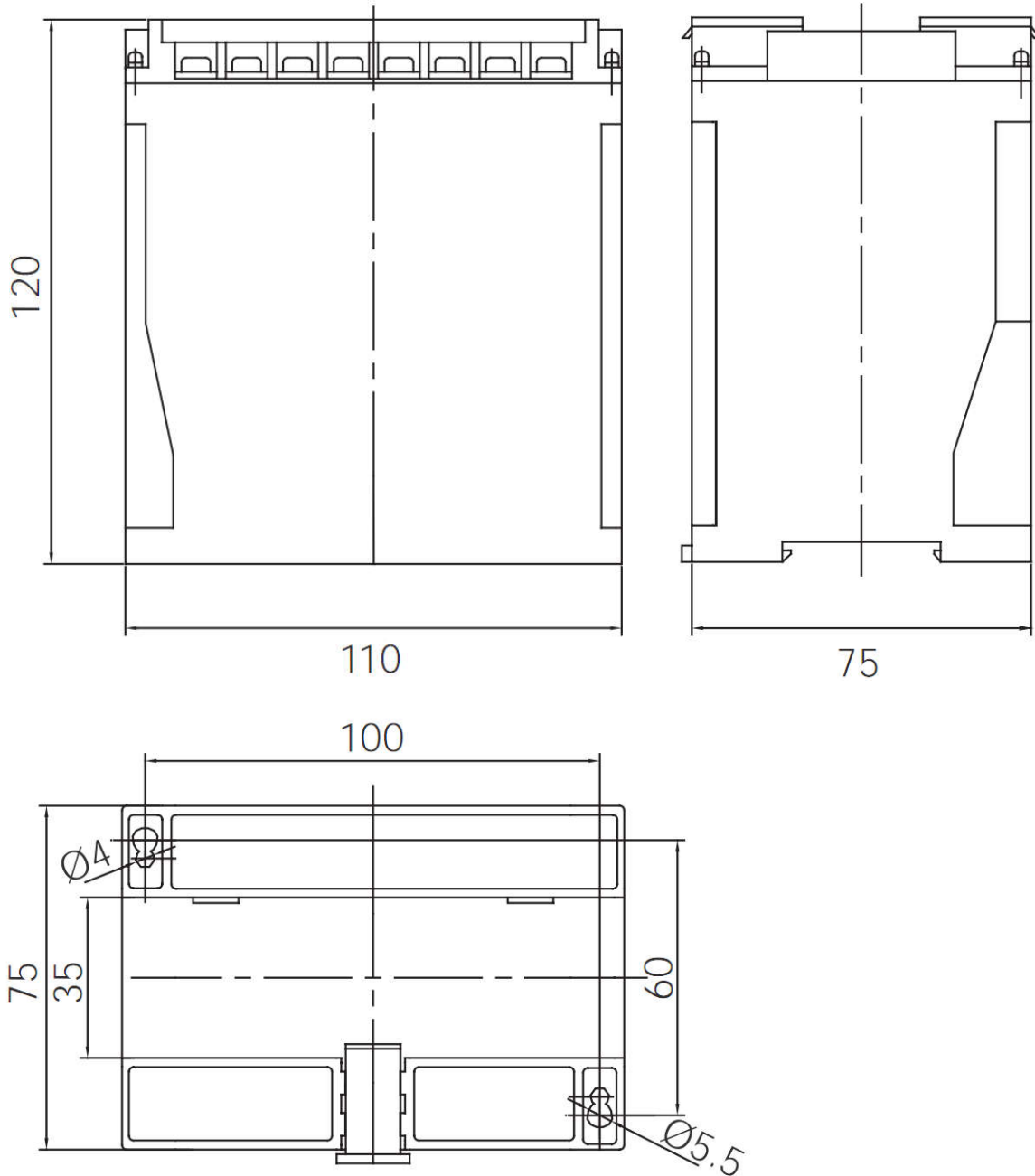

Notes

1. Please confirm the parameter on the label match the order specification
2. Confirm the power supply, input current and voltage
3. Transducer can connect to the CT / PT secondary side

For any inquiry about the instrument performance or whether any failure happens, contact to Blue Jay's technical service.

Blue Jay - After-sales service

*Building 13, 2-8, Jialing third village Pioneer Park,
Jiangbei District , 400020 Chongqing*

Tel - + 0086 023 86850812

Fax - + 0086 023 67636974

E-mail : tech@cqbluejay.com